

GREENACRE ROAD

Pump Performance Curves

(P1) Pump Chamber Details

Rev.	Date	AMENDMENTS	Rev.	Date	AMENDMENTS

Check all dimensions on site before commencing work, report any discrepancies to consultant for clarification. Do not scale from the drawings. This drawing is copyright and remains the property of the Consultants and must not be used, copied or produced in whole or part except by agreement with the consultants.

M.Noaman BE MIE (Aust)  
CONSULTING ENGINEER- STRUCTURAL & CIVIL  
SHOP 2/27-29 MARY STREET, AUBURN, NSW 2144  
FAX: 02-9602 5434 MOBILE 0405 581110  
email: austplex@consultant.com

Project: PROPOSED COMMUNITY CENTER  
AT 68 WATERLOO ROAD ,  
GREENACRE, NSW  
Client: ECO-SPACE DESIGN

Design: M.Noaman  
Drawn: MN  
Scale: 1:100 & 1:20  
PROJECT No:  
ESD02-11/20SW  
Drawing:  
LOWER BASEMENT DRAINAGE PLAN

DRAWING No.  
DA01/4

Date: Nov 2020 Issue A

 DIAL 1100 BEFORE YOU DIG



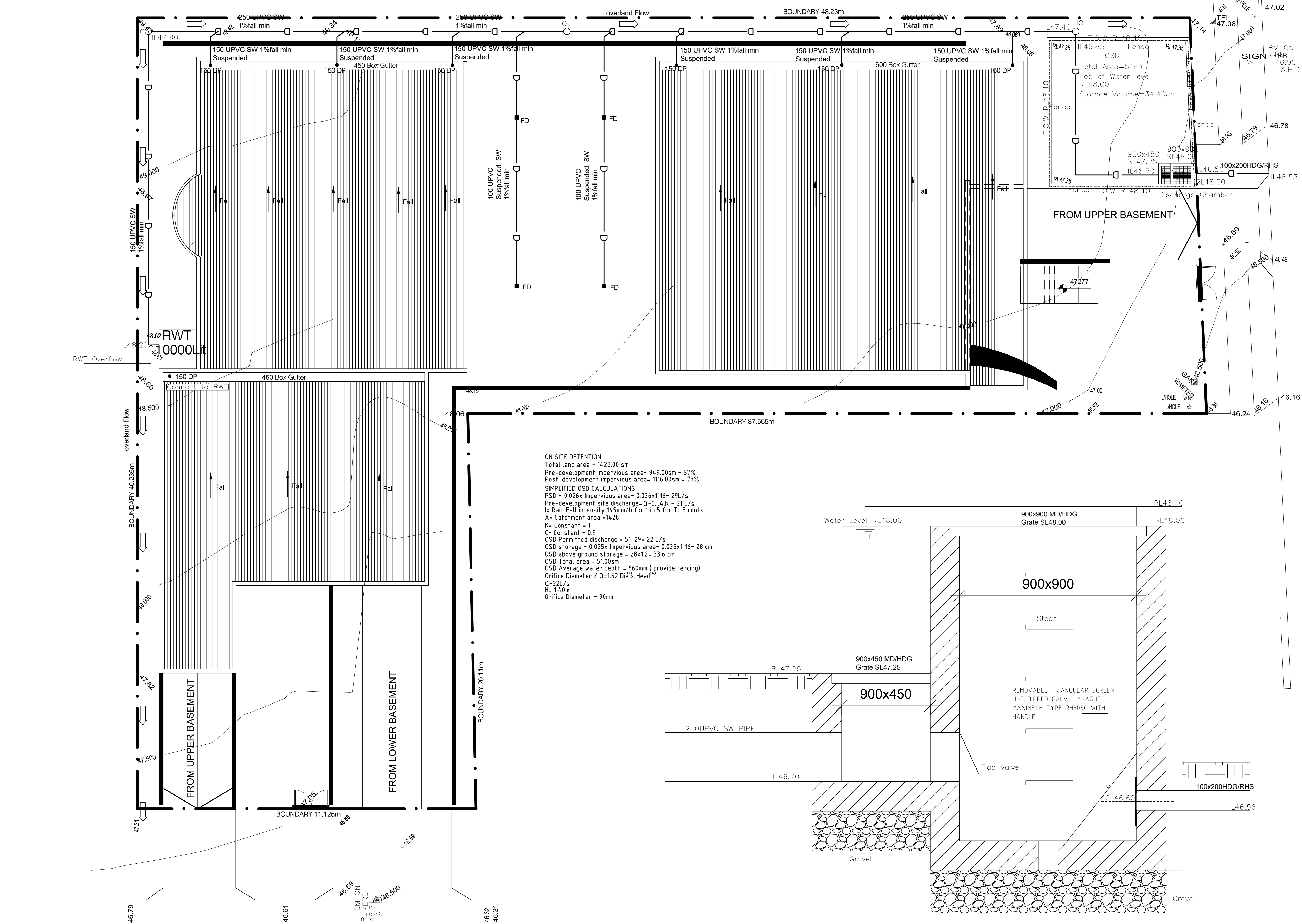
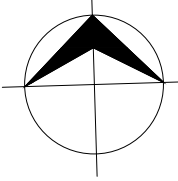

ON SITE DETENTION  
Total land area = 1428.00 sm  
Pre-development impervious area= 949.00sm = 67%  
Post-development impervious area= 1116.00sm = 78%  
SIMPLIFIED OSD CALCULATIONS  
PSD = 0.026x Impervious area= 0.026x1116= 29L/s  
Pre-development site discharge= Q=C.I.A.K = 51 L/s  
I= Rain Fall intensity 14.5mm/h for 1 in 5 for Tc 5 mints  
A= Catchment area =1428  
K= Constant = 1  
C= Constant = 0.9  
OSD Permitted discharge = 51-29= 22 L/s  
OSD storage = 0.025x impervious area= 0.025x1116= 28 cm  
OSD above ground storage = 28x12= 33.6 cm  
OSD Total area = 51.00sm  
OSD Average water depth = 660mm ( provide fencing)  
Orifice Diameter / Q=1.62 Dia<sup>0.5</sup> x Head<sup>0.5</sup>  
Q=22L/s  
H= 1.40m  
Orifice Diameter = 90mm

## DISCHARGE CHAMBER DETAILS

## WATERLOO ROAD

## ORIFICE DETAILS

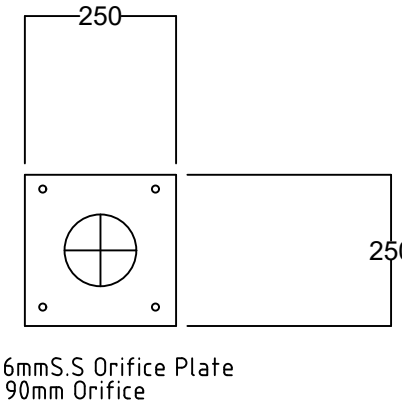

CONFINED SPACE WARNING SIGN

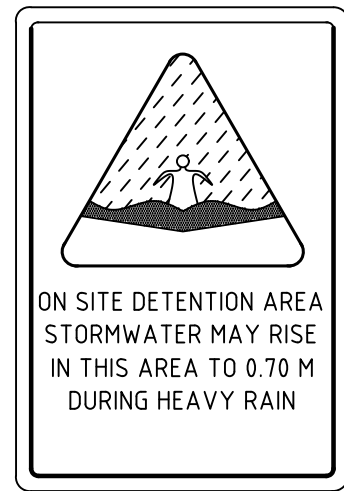

PROVIDE WARNING SIGN  
IN OSD BASIN



Rev.	Date	AMENDMENTS	Rev.	Date	AMENDMENTS

Check all dimensions on site before commencing work, report any discrepancies to consultant for clarification. Do not scale from the drawings. This drawing is copyright and remains the property of the Consultants and must not be used, copied or produced in whole or part except by agreement with the consultants.

**M.Noaman BE MIE (Aust)**  
CONSULTING ENGINEER- STRUCTURAL & CIVIL  
SHOP 2/27-29 MARY STREET, AUBURN, NSW 2144  
FAX: 02-9602 5434 MOBILE 0405 581110  
email: austplex@consultant.com

Project: PROPOSED COMMUNITY CENTER  
AT 68 WATERLOO ROAD ,  
GREENACRE, NSW  
Client: ECO-SPACE DESIGN

Design: M.Noaman  
Drawn: MN  
Scale: 1:100 & 1:10  
PROJECT No:  
ESD02-11/20SW  
Drawing:  
ROOF , GROUND FLOOR & OSD DRAINAGE PLAN  
DRAWING No:  
**DA03/4**  
Date: Nov 2020 Issue A



- |                            |       |
|----------------------------|-------|
| 100 Subsoil Drainage       |       |
| UPVC Stormwater Pipes      |       |
| Over Land Flow             |       |
| On Site Detention          | O.S.D |
| Permissible Site Discharge | P.S.D |
| Stormwater Pit             | P     |
| Floor Drain                | FD    |
| Stormwater                 | SW    |
| Overflow                   | O.F   |
| Rain Water Tank            | R.W.T |
| Down Pipe                  | DP    |
| Invert Level               | IL    |
| Surface Level              | SL    |
| Stack Pipe                 | S     |
| Planter Drain              | SD    |

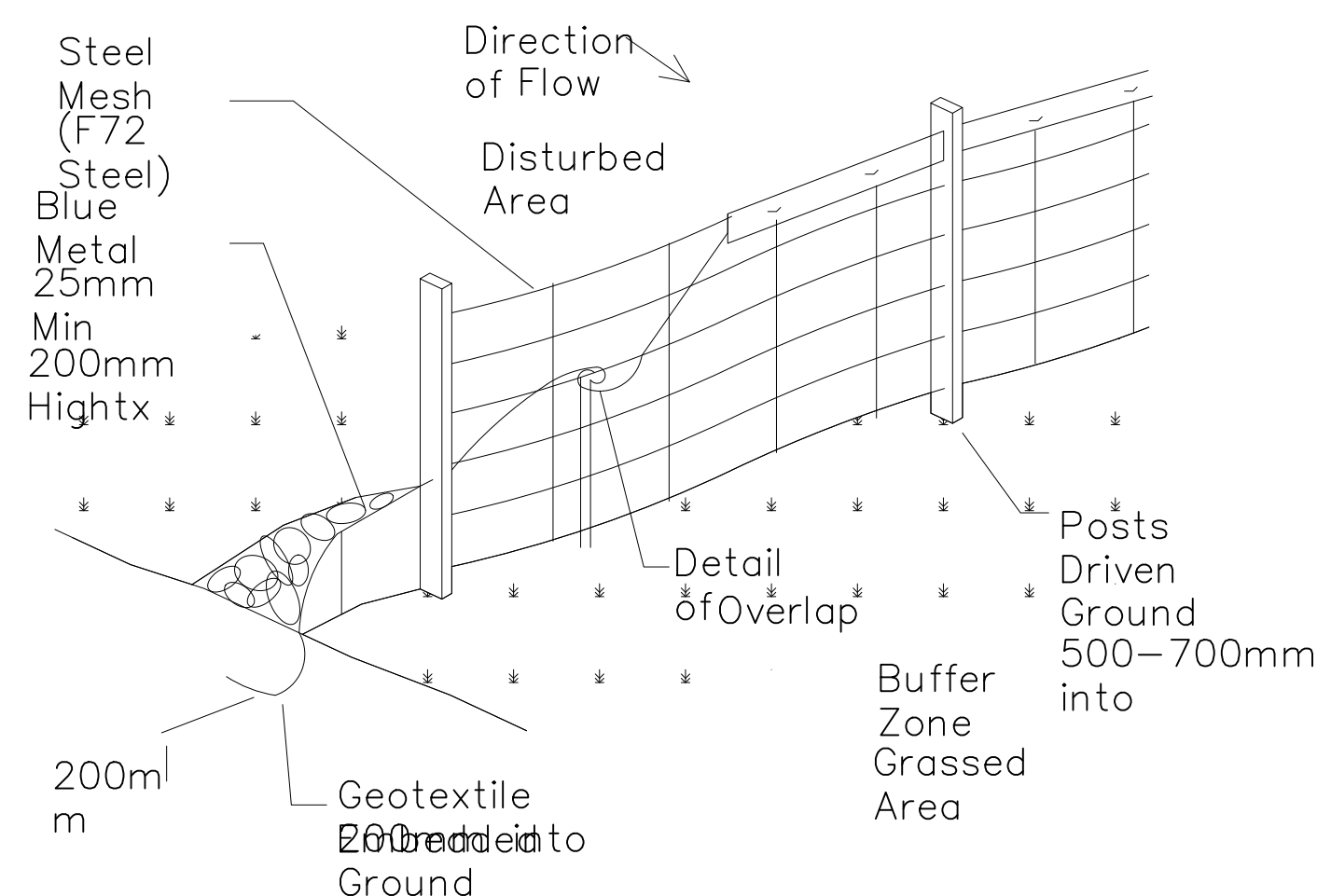

SEDIMENT FENCE N.T.S

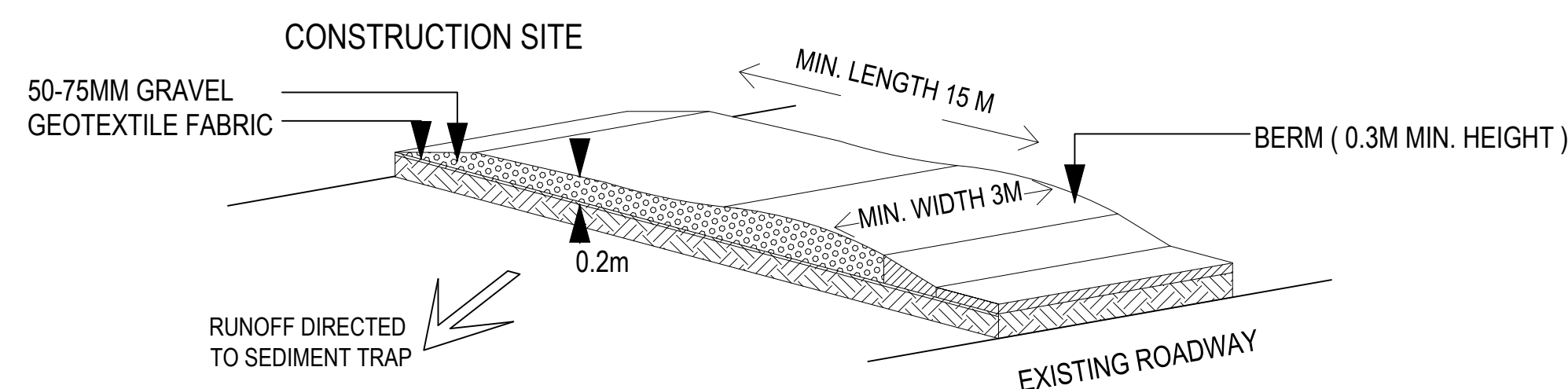

TEMPORARY CONSTRUCTION  
EXIT / ENTRANCE N.T.S.

TEMPORARY 1.8M HIGH WIRE MESH  
FENCE WITH DUSTPROOF MESH  
APPLIED TO FULL HEIGHT TO  
BOUNDARIES AS REQUIRED

LOCATION OF WASTE BINS

SEDIMENT FENCE AS REQUIRED

GRAVEL ACCESS

SITE ACCESS AREA TO BE USED FOR  
WASHDOWN AREA

FOOTPATH CLEAN AND CLEAR AT ALL TIMES

LOCATION OF STOCKPILE MATERIAL

MATERIAL STORAGE AREA

TEMPORARY TOILETS

INSTALL TEMPORARY SEDIMENT BARRIERS TO ALL INLET PITS LIKELY TO COLLECT SILT LADEN WATER, TO COUNCIL'S REQUIREMENTS.

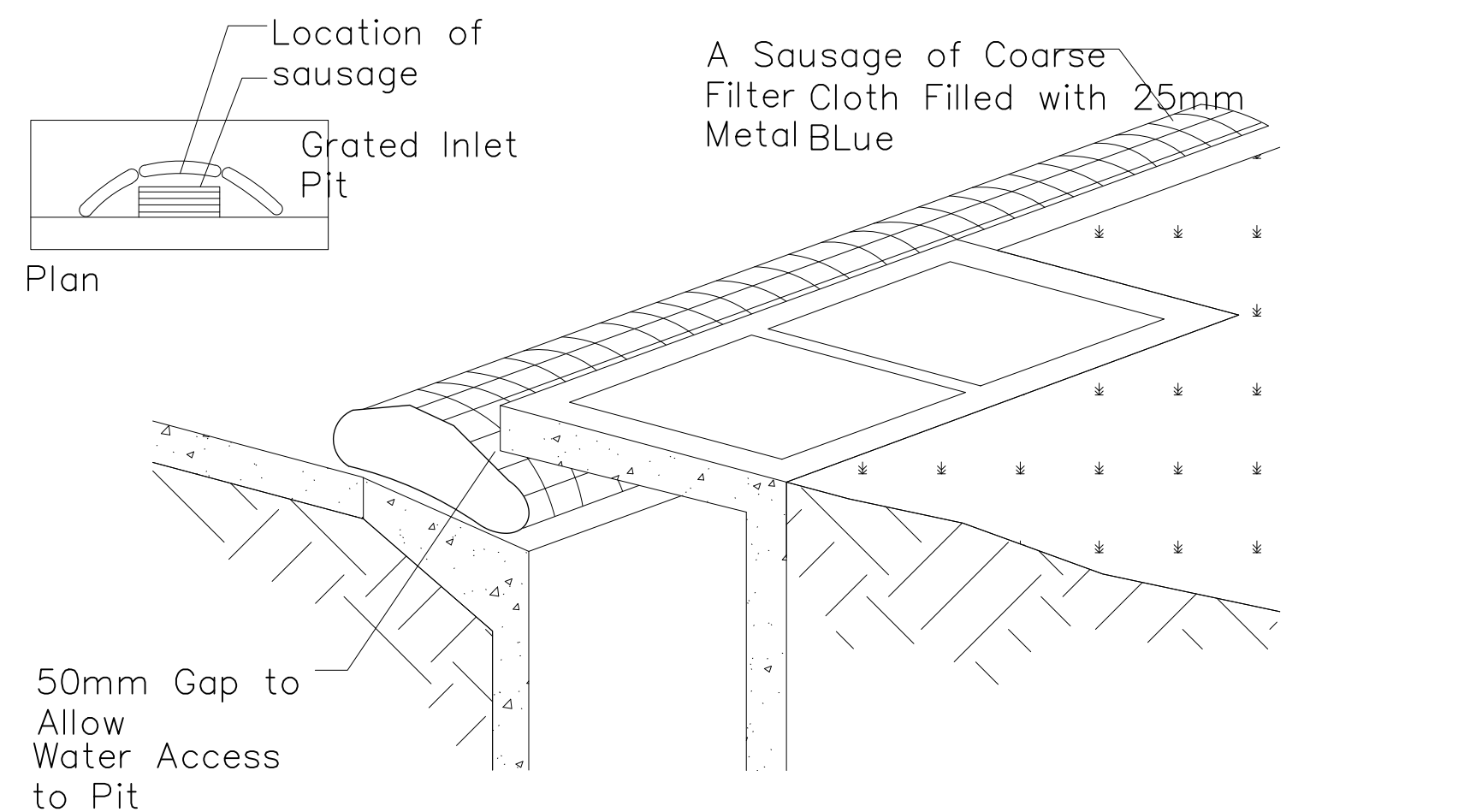

Blue metal groyne  
(sausage)  
Description  
The groyne comprises a sausage of shade cloth or other previous fabric, some 200mm diameter, filled with 25mm blue metal and closed both ends.  
Installation  
The sausage is laid on the ground on the contour similar to a silt fence.  
Generally the sausage

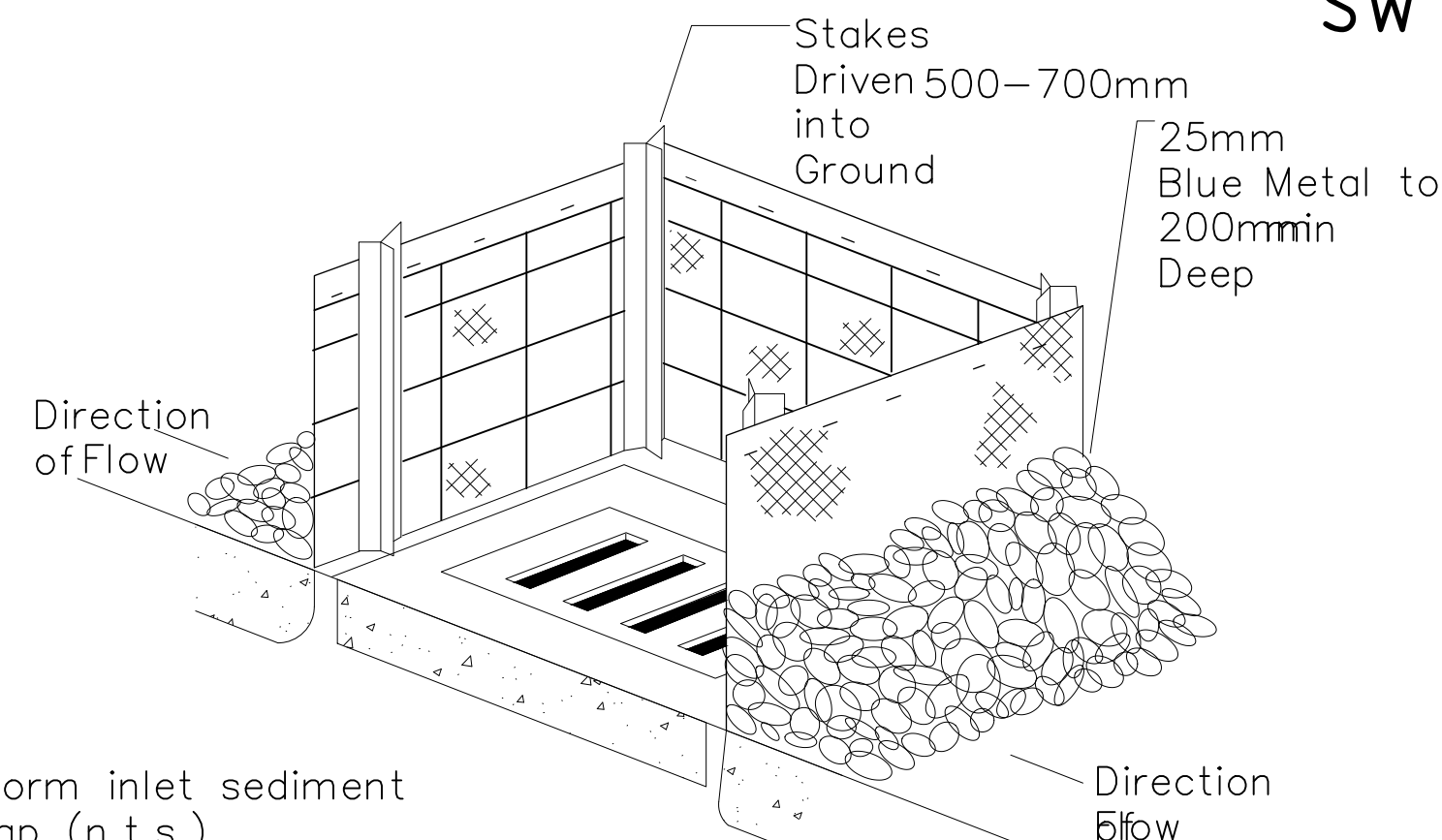

Storm inlet sediment trap (n.t.s.)

Description

These are temporary de-silting structures.

Usage

Such sediment traps are used at stormwater inlets and outlets, culvert entries and points where run-off from disturbed catchments such as construction sites is discharged.

Sediment traps are built from straw bales, washed gravel, gabions or sandbags (or saron type

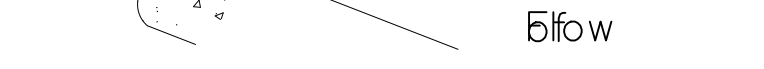

## SOIL AND WATER MANAGEMENT NOTES

01. ALL EROSION AND SEDIMENT CONTROL MEASURES TO BE INSPECTED AND MAINTAINED DAILY BY SITE MANAGER

## 02. MINIMISE DISTURBED AREAS

03. ALL STOCKPILES TO BE CLEAR FROM DRAINS, GUTTERS AND FOOTPATHS.

04. DRAINAGE TO BE CONNECTED TO STORMWATER SYSTEM AS SOON AS POSSIBLE.

05. ROADS AND FOOTPATHS TO BE SWEEPED DAILY  
AND KEPT CLEAN AT ALL TIMES

06. INSTALL TEMPORARY SEDIMENT BARRIERS TO ALL INLET PITS LIKELY TO COLLECT SILT LADDEN WATER, TO COUNCIL'S REQUIREMENTS.

07. NOT WITHSTANDING DETAILS SHOWN, IT IS THE SITE MANAGERS SOLE RESPONSIBILITY TO ENSURE THAT ALL SITE ACTIVITIES COMPLY WITH THE REQUIREMENTS OF THE CLEAN WATERS ACT.

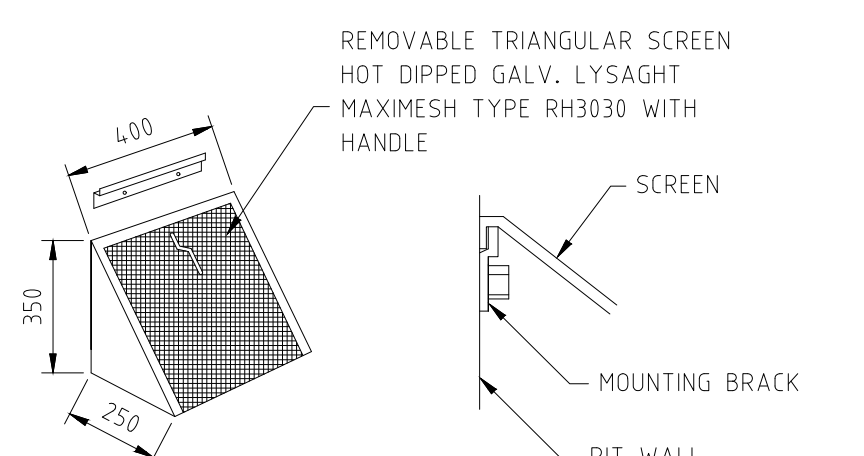

MULTI PURPOSE FILTER SCREEN  
SCALE 1:20  
PRODUCT CODE: MMMPS (MASCOT ENGINEERING)

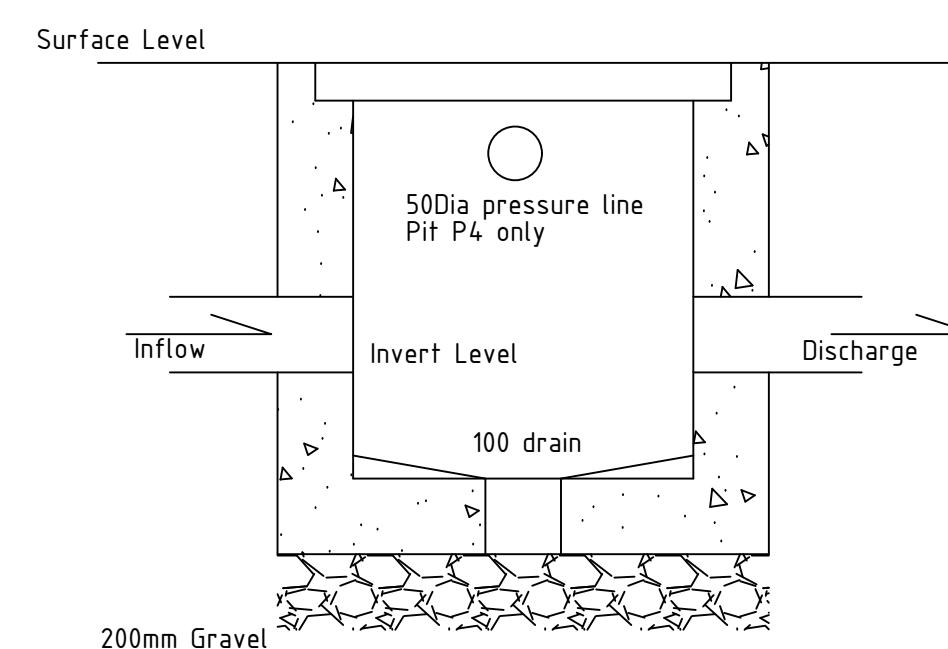

## SW Pits Standard Details

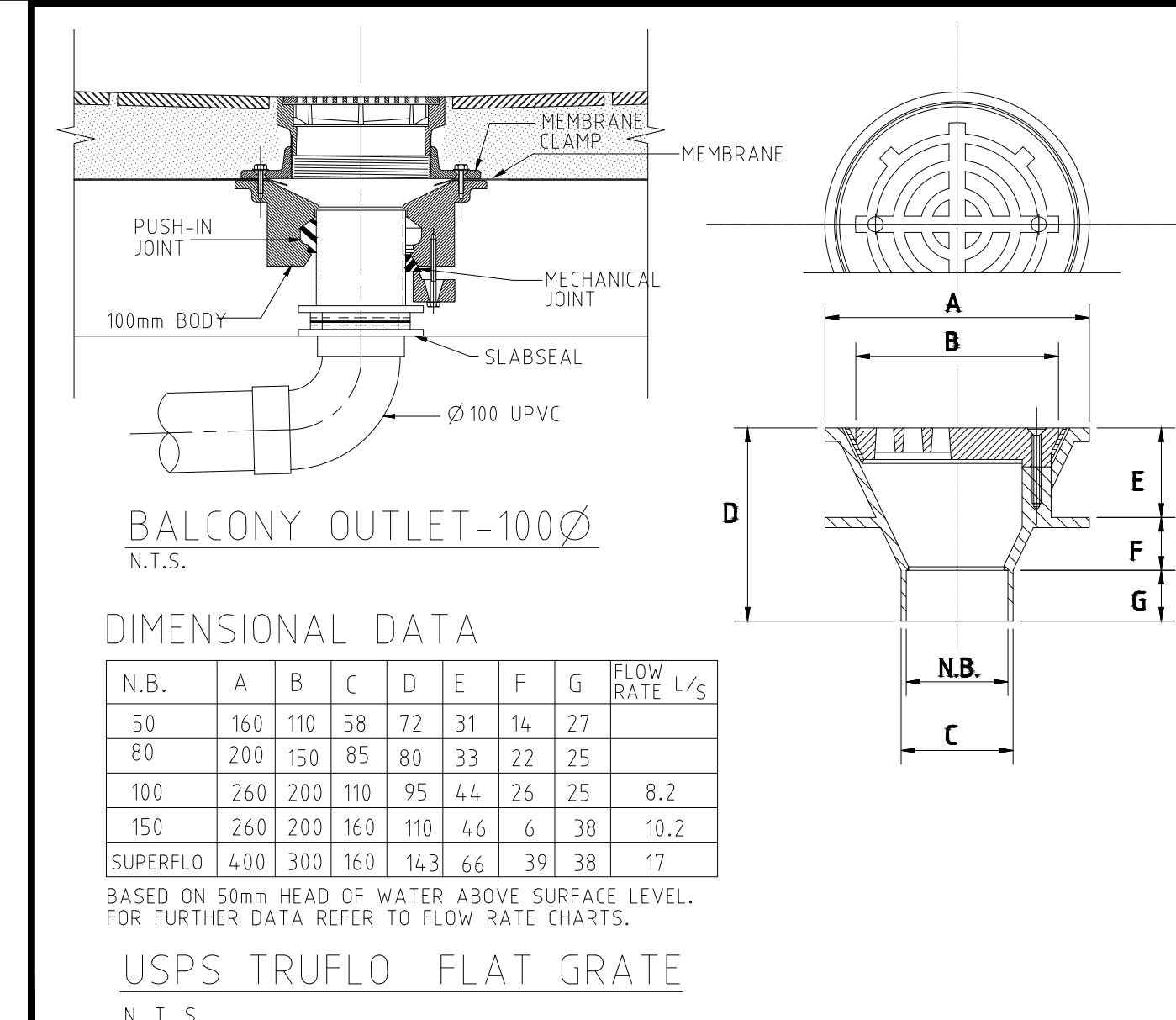

Stakes 600mm into the Ground

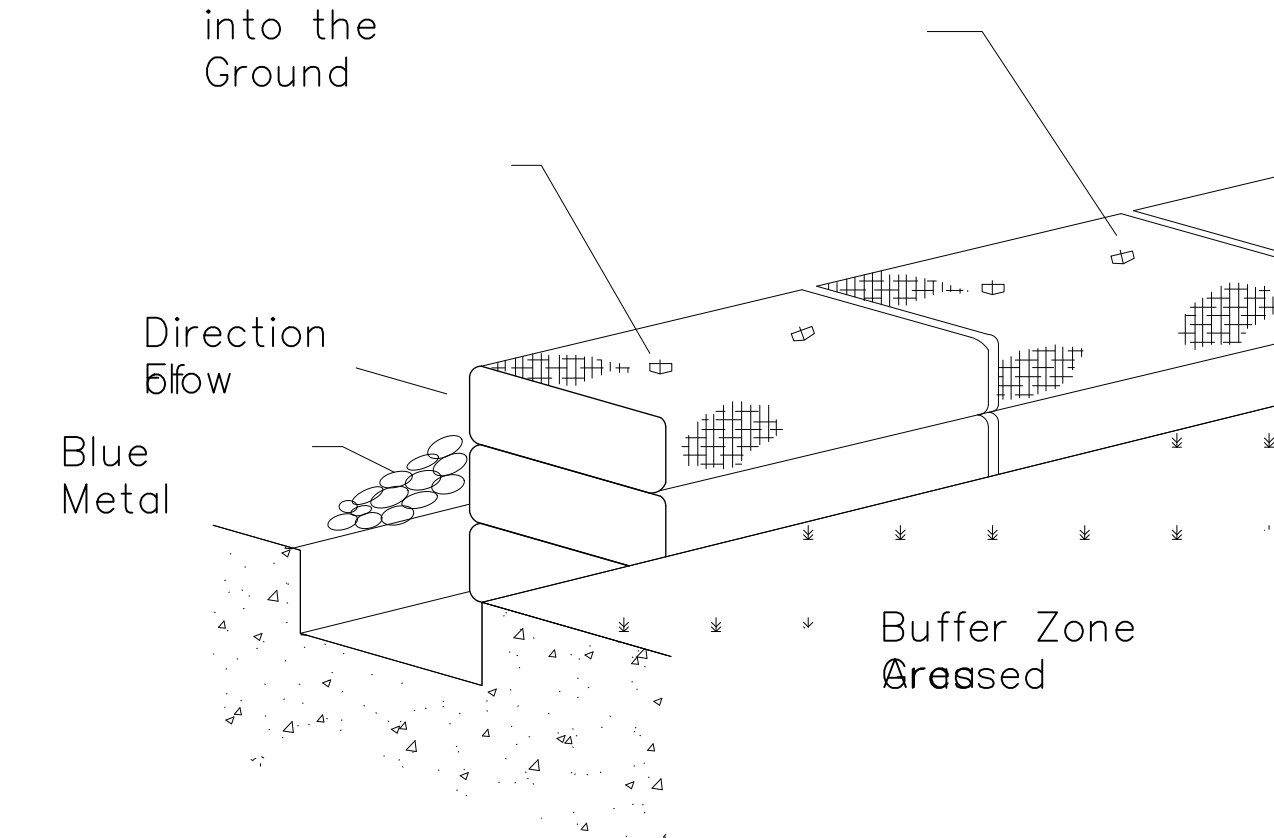

Straw bale barriers	
Description	A temporary barrier of straw bales placed around the perimeter of a disturbed area.
Usage	Straw bale barriers are used to desilt contaminated water.

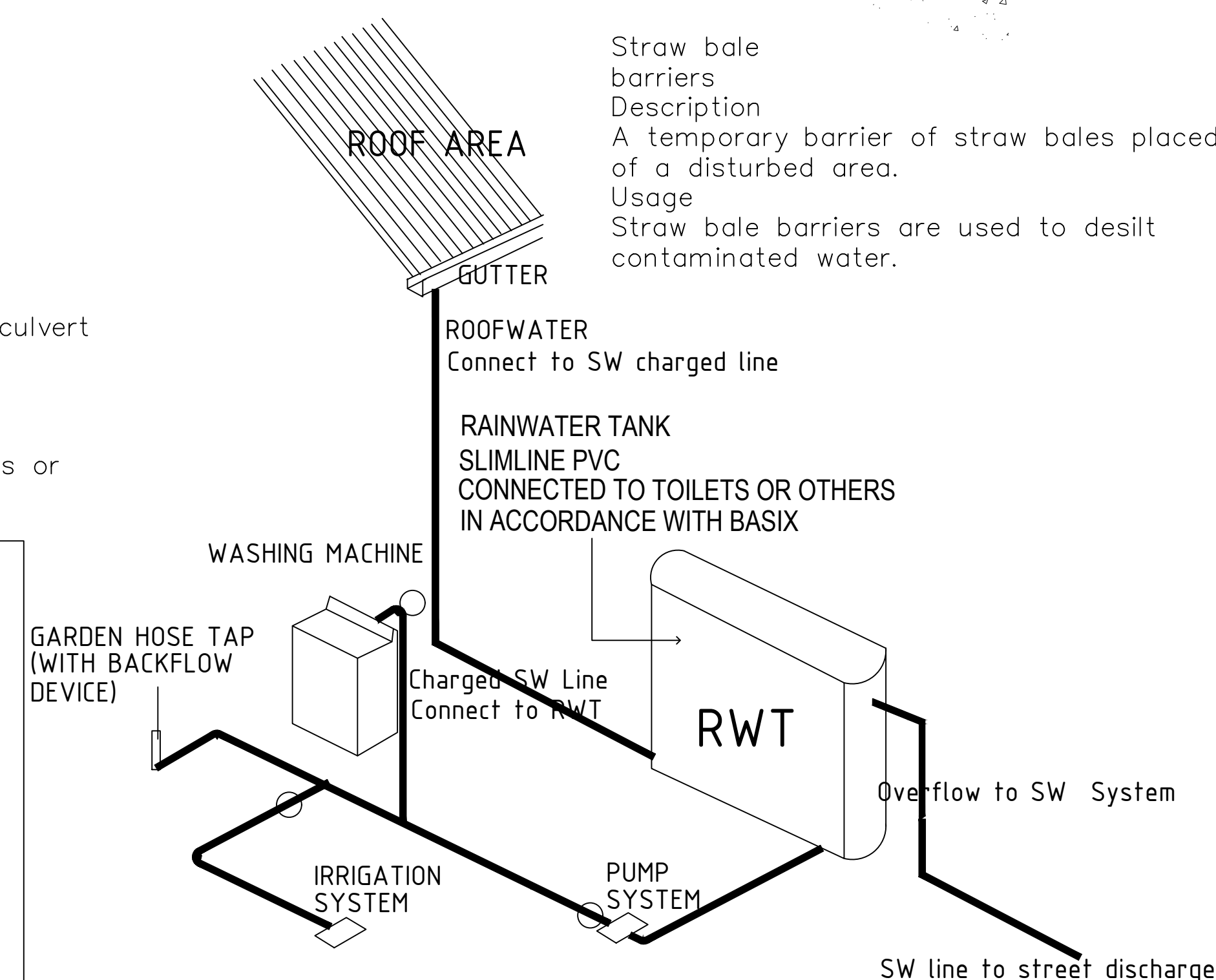

# RAINWATER TANK DETAIL SCHEMATIC



**DIAL 1100 BEFORE YOU DIG**

[illegible]

Check all dimensions on site before commencing work, report any discrepancies to consultant for clarification. Do not scale from the drawings. This drawing is copyright and remains the property of the Consultants and must not be used, copied or produced in whole or part except by agreement with the consultants.

**M.Noaman BE MIE (Aust)**  
CONSULTING ENGINEER- STRUCTURAL & CIVIL  
SHOP 2/27-29 MARY STREET, AUBURN, NSW 2144  
FAX: 02-9602 5434 MOBILE 0405 581110  
email: [austiplex@consultant.com](mailto:austiplex@consultant.com)

Project:  
PROPOSED COMMUNITY CENTER  
AT 68 WATERLOO ROAD ,  
GREENACRE, NSW  
Client:  
ECO-SPACE DESIGN

Design: M.Noaman
Drawn: MN
Scale: 1:100 & NTS
PROJECT No.
ESD02-11/20

DRAWING No.  
**DA04/4**

	Date: Nov 2020	Issue A
--	----------------	---------

# MANAGEMENT PLAN